



RIVA Facade

Riva Facade shown on Eastleigh 25. Illustration purposes only. Please refer to working drawings.

LIMITED TIME ONLY

Indoor & Outdoor Packs Included!

PLUS

Kitchen & Flooring Packs Included!

FIRST HOME BUYER PRICE \$498,900

\$508,900*

Scan QR code below to view more details on this home design.



Lamont22

Lot 331 Metroon Drive WEIR VIEWS

Lot Size: 448m²

RIVA facade



Fixed Price Package Inclusions

- + Fixed price site costs
- + Estate Covenants
- + Gas Ducted Heating
- + 600mm wide stainless steel oven and cooktop
- + Wall tiles to ensuite, bathroom and laundry Category 1
- + Colorbond garage roller door
- + Guaranteed site start
- + Award winning designs and interiors
- + Award winning designs and interiors

Contact Erick Sutedja 0435294220

porterdavis.com.au

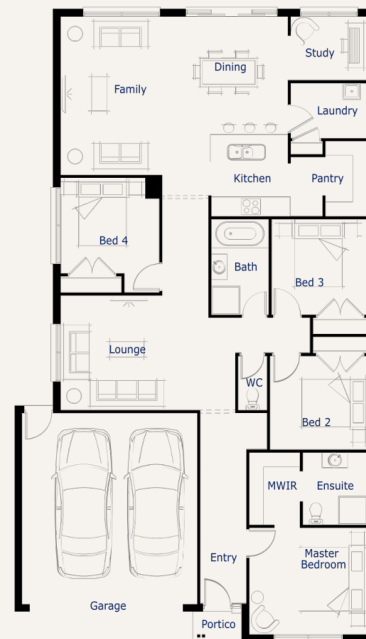

*Terms & Conditions: Package price is based on standard home, standard facade unless specified, builder's preferred siting and current promotion. Refer to sales consultant for actual working drawings for available facade options and inclusions. Pricing may vary due to actual land availability. Porter Davis reserves the right to change prices without notice. Fixed price packages are subject to developer's design review panel for final approval. First Home Buyer price less First Home Owner Grant subject to SRO eligibility criteria. If required via a town planning permit, client must provide landscaping and fencing etc at their own cost. Photos for illustration purposes only and include examples of upgrades not included in the package price. Refer to working drawings. Guaranteed site start subject to land title and finance availability. Geographic build zones apply. BAL rating up to 12.5 included, based on the standard home and specification. Should client variations after the requirements to achieve compliance, Porter Davis will debit or credit the client via a post contract variation. Package price correct at 14-08-2020.



6x Winner



12x Winner